

NOT FOR FIELD USE	
<input type="checkbox"/> Eligible	<input type="checkbox"/> Nominated
<input type="checkbox"/> Det. Not Eligible	<input type="checkbox"/> Certified Rehab.
Date _____	

**HISTORIC BUILDING INVENTORY RECORD**

CODE #: 4571

PROJECT Littleton Historic Resources Survey, NAME: 2000-01, SHF#2000-01-069		COUNTY: Arapahoe	CITY: Littleton	STATE ID NO.: 5AH1725
CURRENT BUILDING NAME:		OWNER: GARFEIN, ANITA B		
ADDRESS: 3986 W BOWLES AVE LITTLETON, 80120		3986 W BOWLES AVE LITTLETON CO 80123-6582		
HISTORIC NAME: Hunter Residence		TOWNSHIP: 5S RANGE: 68W SECTION:19 NW 1/4 NE 1/4		
DISTRICT NAME:		USGS 7.5' QUAD. NAME: Littleton, Colo. YEAR: 1965. r. 1994		
FILM ROLL NO.: 00-34 BY: Roger Whitacre		NEGATIVE NO.: 5	LOCATION OF NEGATIVES: Littleton Hist. Mus.	DATE OF CONSTRUCTION: ESTIMATE: ACTUAL: 1889 SOURCE: Littleton Indep., 4-27-76
ATTACH PHOTOGRAPH HERE		PRESENT USE: Domestic/Single Dwelling		
		HISTORIC USE: Domestic/Single Dwelling		
		CONDITION: Excellent		
		EXTENT OF ALTERATIONS: Moderate DESCRIBE: Attached garage on west. House moved further back on same lot. <span style="float: right;">CONT.? No</span>		
STYLE: 19th and 20th Cent. Rev./Colonial Rev.		STORIES: 2 1/2		
MATERIALS: Wood		SQ. FOOTAGE: 2714		
ARCHITECTURAL DESCRIPTION: Two-and-a-half-story side gable roof frame dwelling with gabled projection on front and rear. Composition roofing. Full-height brick chimney on east with flue liner caps. Flared, overhanging eaves. Walls clad with wood shingles; gable ends clad with fishscale shingles. 1/1-light double-hung sash windows with wide wood surrounds. Projecting gable roof porch with square column supports and balustrade; porch wraps around. Off-center entrance with glazed screen. Gable ends have 3/1-light double-hung sash windows. Hipped roof dormer on rear clad with asbestos shingles has three double-hung sash windows. Garage addition on west is shingled and has large paneled overhead door. Frame outbuilding with gable roof and vertical panel siding. Large privacy fence in front of property. <span style="float: right;">CONT.? No</span>			MOVED? Yes DATE(S) OF MOVE: 1987	
			NATIONAL REGISTER ELIGIBILITY: INDIVIDUAL? Not Eligible	
			CONTRIBUTING TO DISTRICT?	
			LOCAL LANDMARK DESIGNATION? No NAME: DATE:	
ADDITIONAL PAGES? No			ASSOCIATED BUILDINGS? Yes TYPE: Outbuilding IF INVENTORIED, LIST ID NOS.:	

**PLAN SHAPE:**

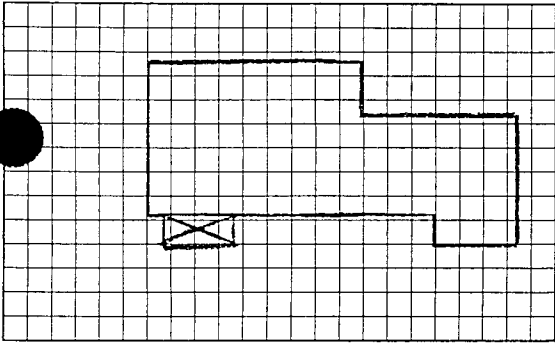

**ARCHITECT:**  
Unknown

**STATE ID NO.:** 5AH1725

**SOURCE:**

**ORIGINAL OWNER:**  
D.M. Hunter

**BUILDER/CONTRACTOR:**  
Unknown

**SOURCE:** Littleton Indep., 4-27-76

**SOURCE:**

**THEME(S):**  
Rail Era: Rail Town Phys. Form,  
1870-1920

**CONSTRUCTION HISTORY:**

CON'T.? No

A number of additions have been made since the original construction.

**HISTORICAL BACKGROUND:**

CON'T.? No

Shirley Smith reported that this house was built by Presbyterian minister D.M. Hunter in 1889. The house was threatened by the Bowles Avenue expansion project in the late 1980s. The house is described in a 1986 Littleton Independent article as the rural home of the minister of the First Presbyterian Church. In order to save the house during expansion of the road, the building was moved from its original foundation and placed further back on the lot. The city of Littleton paid \$100,000 to move the house in 1987. That report stated that Hunter had purchased a two-acre site from John Lilley in 1888 for \$200 and the house was built in 1889. The foundation was reportedly built using mud from the South Platte River and included pieces of crockery and other materials. In 1891, Hunter sold the residence to R.H. Nelson for \$4,000. A succession of owners followed, including Charles H. Hammer, who was a pigeon raiser.

**LITTLETON LANDMARK ELIGIBILITY:**

**INDIVIDUAL?** Yes

**CONTRIBUTING TO DISTRICT?**

**DISTRICT NAME:**

**SIGNIFICANCE CATEGORIES:**

**ARCHITECTURAL SIGNIFICANCE:**

**HISTORICAL SIGNIFICANCE:**

REPRESENTS THE WORK OF A MASTER

ASSOCIATED WITH SIGNIFICANT PERSONS

POSSESSES HIGH ARTISTIC VALUES

X ASSOCIATED WITH SIGNIFICANT EVENTS OR PATTERNS

X REPRESENTS A TYPE, PERIOD, OR METHOD OF CONSTRUCTION

CONTRIBUTES TO AN HISTORIC DISTRICT

**STATEMENT OF SIGNIFICANCE:**

CON'T.? No

This house reflects features of the Colonial Revival style through its pedimented gables, double-hung sash windows, and porch with column supports. The house is associated with the early development of Littleton's formerly rural areas.

**REFERENCES:**

CON'T.? No

Arapahoe County Assessor records; Sentinel Independent, 20 March 1987; Littleton Independent, 27 June 1986 and 27 April 1986.

**SURVEYED BY:** R.L. Simmons/T.H.

**AFFILIATION:** Front Range Research Associates, Inc.

**DATE:** May 2001

STYLE NO. 35-8P

P.O. BOX 607638 • ORLANDO, FL 32860 • (407) 886-310

**PrintFile**<sup>®</sup>  
ARCHIVAL PRESERVERS

